



SOLUTIONS FOR BROADCASTERS

PERFECT VISUAL SOLUTIONS



PERFECT VISUALISATION SOLUTIONS FOR BROADCAST APPLICATIONS INNOVATIONS “MADE IN GERMANY”.



TV studios, video- and sound-control rooms, TV operations centres, playout-centres, newsrooms, post-production, inspection-and-approval suites – the fields of application for visualisation technologies in the broadcasting sector are many and varied. And particularly in this demanding environment it is effectively the quality of the components used which determines that what finally lands on the screen corresponds to the quality expected by the viewer. From the recording in the studio or outdoors, the work of the director and the interplay with the post-production team, the synchronisation and the final cut – everything must function like clockwork whilst visualisation is achieved at a constantly high level.

In this production process the solutions provided by eyevis guarantee perfect images – from the production stage up to transmission. The consistent optimisation of our products for the exacting demands in broadcasting applications includes further developments in the precision of reproduction of the required colour temperature, special inputs and timings for broadcast-specific signals, synchronous display with the in-house frequency (genlock), but also the optimisation of sound quality in the various application areas in the studio.

In addition to the excellent picture quality and high reliability of the various display technologies eyevis can also score with the flexibility of its applications. In our wide-ranging palette of products customers find solutions for every type of application in the field of broadcasting and audiovisuals. Whether it is a bezel-free video wall or creative display arrangement in the studio background, dependable presentation in the control room, ultra-HD screens for editing or preview monitor for the production - our catalogue offers the appropriate product for every broadcaster.

In the realisation of your project you will profit from our own understanding of our company as a provider of solutions, above all from our comprehensive know-how in the field of image-producing technologies. From planning to installation up to the servicing of existing facilities we are at your side as competent partners to assist you in the realisation of your ideas and concepts. And also, if your project demands special solutions or developments, in this area too eyevis has already demonstrated its expertise and flexibility many times.

WE'RE AT HOME HERE.

SOLUTIONS FOR
TELEVISION STUDIOS



SOLUTIONS FOR
CONTROL ROOMS



SOLUTIONS FOR
PRODUCTION



OPERATING WORLDWIDE MISSION CUSTOMERS WHO PUT THEIR TRUST IN EYEVIS TECHNOLOGY.



ALJAZEERA BALKANS NEWS STUDIO IN SARAJEVO, BOSNIA-HERZEGOVINA

Aljazeera Balkans in Sarajevo is one of the stations of the news network based in Qatar which lies outside the Arab world. This TV station in the Bosnian capital consists of a complete production platform with state-of-the-art technology which includes the adjacent studio as well as the extensive live-broadcast facilities for outdoor transmissions.

The studio has an impressive video wall consisting of a total of 27 eyevis DLP®-Cubes with eyevis LED-technology. The advantage of these cubes is that their colour temperature can be perfectly adapted to the conditions of the TV studios. In order to keep the noise level of the video wall as low as possible the soundproofed version of the eyevis Cubes is in use. The video wall is constructed in a curved shape, so that an optimal perspective from any camera position is possible.

Equipment used:

- 27x EC-60-LHD-BB (60" DLP® cube with LED-lighting, Full HD resolution and BlackBead-screens)



THE TV-STUDIO OF NEDERLANDSE OMROEP STICHTING (NOS) IN HILVERSUM, THE NETHERLANDS

With their varied screen formats, their minimal installation depth and the possibility to adapt the colour temperature to the conditions for TV recordings, omniSHAPES provide the ideal solution for the dynamic design of the video walls in the studios of the news - and sports formats of the public broadcaster NOS.

The studios can be remodelled for each programme and thereby give each format its own distinctive character. No less than 274 omniSHAPES are installed in various video walls in studios seven and eight in the broadcasting centre of NOS near Hilversum. Larger video wall configurations are built on a revolving platform and installed on an air-cushioned substructure, so that they can be used in either studio.

Equipment used:

- 274x omniSHAPES (flexible DLP® rear-projection units in a variety of screen shapes)



THE VRT CANVAS TV-STUDIO IN BRUSSELS, BELGIUM

In the studio of the well-known Belgian TV-channel Canvas, which belongs to VRT (Vlaamse Radioen Televisieomroep, broadcasting to the Flemish-speaking community) the flexible squareTILES from eyevis provide a very special visual kick.

These relatively small LCD-monitors with their unusual quadrilateral format of 39×39 cm differ from the majority of displays commonly found on the market. They offer a high degree of flexibility in daily practice and have many other advantages which make them first choice when you are looking for an unusual Installation with "that certain something".

The installation, made up of a total of 25 squareTILES, is mounted on a movable construction so that it more than fulfils the requirements of flexibility in day-to-day use in the various TV-productions.

Equipment used:

- 25x squareTILES LCDs (quadrilateral LCD modules with 21.6" screen diagonal and Direct-LED backlight)



CONTROL ROOM OF THE VIRTUAL STUDIOS OF THE GERMAN BROADCASTER, DEUTSCHE WELLE, IN BONN

When the TV-activities of the German broadcaster's foreign service in Bonn were being extended, Wellen+Nöthen, one of the leading German trading and system houses in the broadcasting and media sector, were responsible for the technical realisation of the new production facilities. The background is the multi-media orientation of the foreign broadcasting service Deutsche Welle and the consequential strengthening of the TV- and video productions in further languages. The aim is to significantly extend the offer of diverse commentaries, interviews, screen casts, discussions between experts and live spots.

At the heart of the virtual studio system are 2D/3D-realtime rendering engines with which virtual studio productions can be graphically edited. For monitoring in the control room four 55" LCD-monitors from eyevis were used. The monitors of the type EYE-LCD-5500-M-LE-BC are specially developed screens for broadcasting applications which, apart from the required signal-timings also provide the necessary connections.

Equipment used:

- 4x EYE-LCD-5500-M-LE-BC (55" LCD-monitor for broadcast-applications with Edge-LED backlight technology and Full-HD-resolution)

SPECIAL SOLUTIONS FOR SPECIAL REQUIREMENTS TECHNOLOGY AND KNOW-HOW FOR BROADCASTERS.

FASCINATING PROGRAMMES NEED COMPELLING IMAGES AND EXTRAORDINARY VISUALISATION SOLUTIONS

The specifications for the visualisation system in a TV studio are exceptionally high. Reliable display, perfect image quality and the greatest possible flexibility are needed. The type and quality in which external contributions are presented has a real effect on the success of the whole programme format.

For precisely this reason eyevis offers absolutely reliable display technology in perfect quality and with extreme reliability of operation. Whether video wall systems on the basis of DLP® rear projection units, seamless LCD-screens, high resolution LED modules or extraordinary display solutions such as squareTILES and omniSHAPES, or LCD monitors for production and editing – together with you as a customer we realise solutions which are individually and optimally matched to the most diverse tasks.

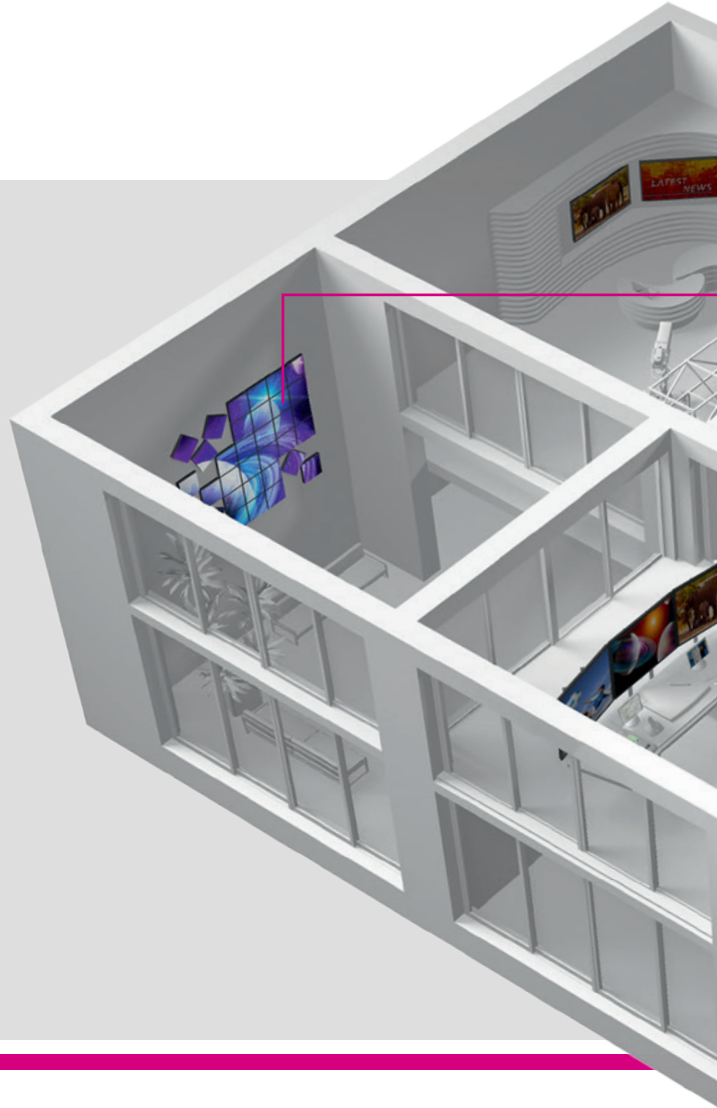

OUR PRODUCTS IN USE

) **squareTILES**
EYEVIS MICROLINE

) **omniSHAPES**
EYEVIS MICROLINE

) **ecCUBE®**
EYEVIS REAR PROJECTION LINE

) **eyeLCD**
EYEVIS LCD LINE

) **eyeLED**
EYEVIS SMD LINE

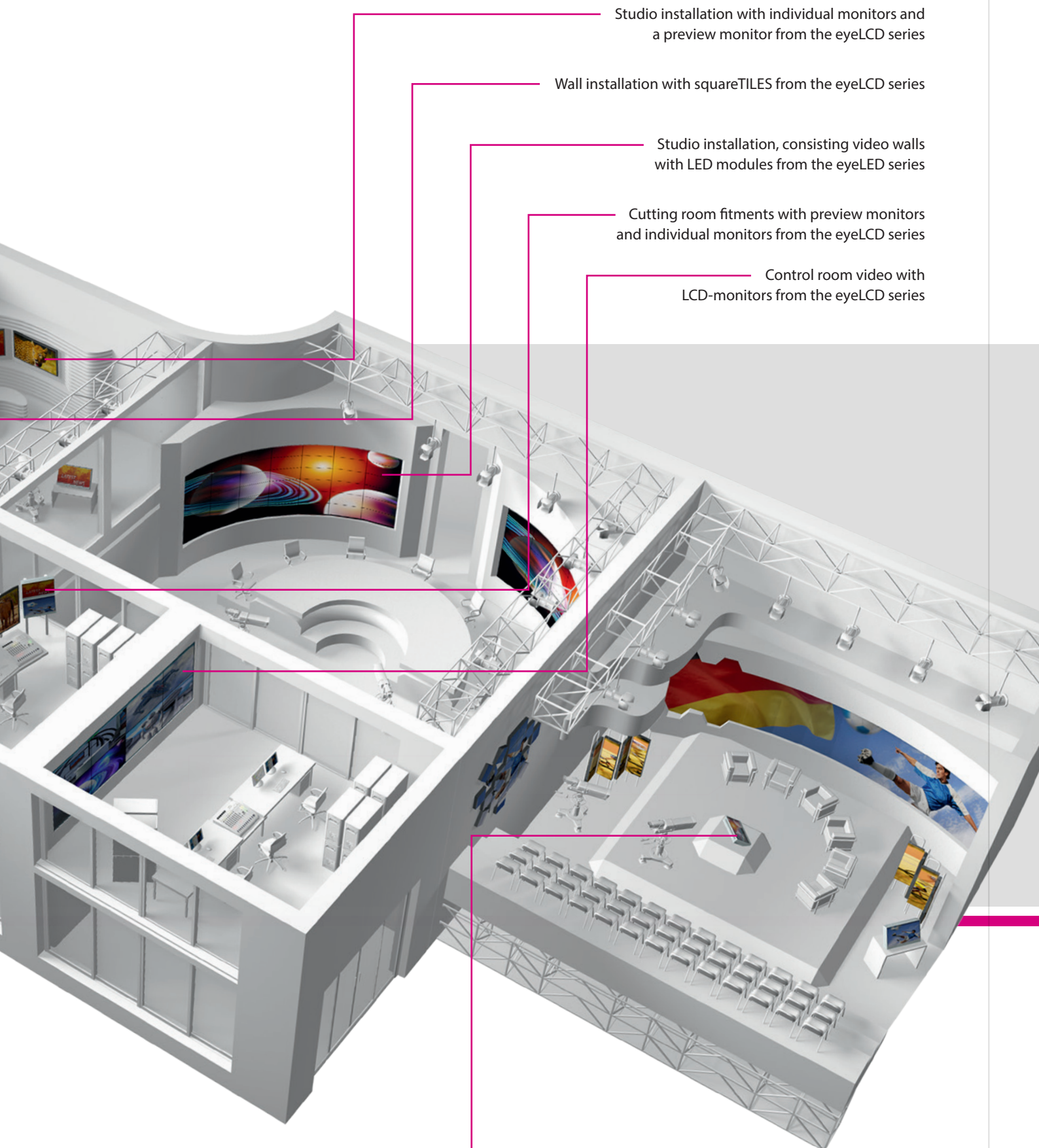

Studio installation with individual monitors and a preview monitor from the eyeLCD series

Wall installation with squareTILES from the eyeLCD series

Studio installation, consisting video walls with LED modules from the eyeLED series

Cutting room fitments with preview monitors and individual monitors from the eyeLCD series

Control room video with LCD-monitors from the eyeLCD series

Studio fitments consisting of a wall installation with squareTILES, flexible installations each with squareTILES, and a preview monitor, all from the eyeLCD series. Video wall with omniSHAPES in a variety of screen forms from the eyevis Microline.

PERFECT INTERPLAY OF FUNCTIONS SYSTEM COMPONENTS FOR BROADCASTERS.



THE REAR PROJECTION CUBES FROM THE ecCUBE SERIES

Where seamless video walls are needed as backdrops in TV studios eyevis-Cubes, with their tried and tested DLP®-technology are first in line. Absolute dependability, even with 24/7 operation, the possibility to realise practically “seamless” video walls and excellent display properties – these are the great advantages of this technology.

With the ecCube series eyevis offers you a portfolio of rear-projection cubes which with regard to variety and optional features is second to none. With screen diagonals of 50” to 100” and resolution from XGA (1024 × 768 px), SXGA+ (1400 × 1050 px), Full HD (1920 × 1080 px), WUXGA (1920 × 1200 px) and now also WQXGA (2560 × 1600 px) a solution for every application can be found. The latest version of our LED-Cubes uses innovative Cluster-LEDs as light source for the projector. These do not only provide higher brightness levels but enhanced reliability and less power consumption.

Particularly for use in TV studios the Cubes are available with a multitude of optimised features, for instance a diverse palette of screen options, special scalers for fully-synchronised presentation with the studio frequency, sound-insulated casings and customer-specific solutions for the construction of the video wall, for example if this should be L-shaped or movable within the studio.

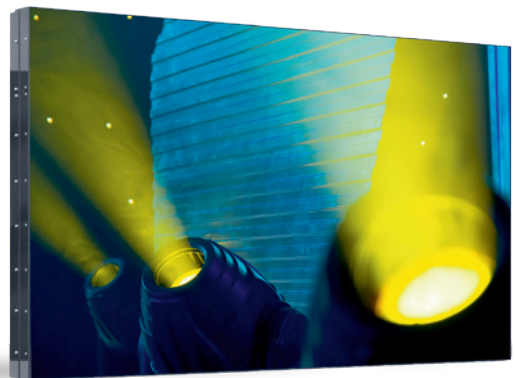

THE LCD MONITORS FROM THE eyeLCD SERIES

Every display from our eyeLCD series is a product of the highest quality which can meet the most stringent demands in professional broadcasting or industrial applications. Pin sharp imagery down to the smallest detail, that is our aim. Thanks to adjustable colour temperature and extraordinary brightness and contrast properties the most diverse projects can be mastered, even under difficult light conditions.

For video wall constructions we offer you modular LCDs with ultra-narrow frames and with various resolutions. For applications in studios these are specially optimised for the display of appropriate colour temperatures.

As well as a list of Full HD LCD monitors up to a 90” screen diagonal we also offer high resolution 4K/Ultra-HD-monitors with 4× Full HD resolution (3840 × 2160 px) with screen diagonals of 31.5”, 60” and 84”.

The specially developed broadcast-versions of the LCDs include extra functions such as sensor-calibration and HD-SDI-inputs as well as enhanced settings for colour temperature and gamma-curves. Touch screens can be provided for all models.

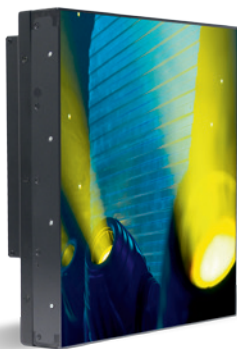

squareTILES – PERFECTLY SQUARE

Small, square LCD-monitors which, due to their dimensions and technical properties, are perfect for creative constellations in modular video walls – these are the eyevis squareTILES.

With width-to height proportions of 1:1 these square 21.6"-LCDs, compared with today's typical 16:9 displays, create a rather exotic effect. And this is precisely their strength. Thanks to their slim casing frame, practically seamless presentations with the smallest possible gaps between the image content of individual monitors are possible. squareTILES can be used for a modular construction, to create video walls or installations in the form of a single surface or as an arrangement of individual monitors. Thanks to their internal image processing, squareTILES can also easily be tilted or offset to achieve a visual impact with a remarkable eye-catching effect.



eyeLED – SEAMLESS, SHARP AND BRIGHT

With the new LED modules of the eyeLED-series eyevis presents LED technology in never before seen sharpness. Thanks to minimal pixel pitch the viewer – even from a very close position – experiences an overwhelmingly sharp image. This effect is further enhanced by impressive brightness and lack of any disturbing bezels. The new LED modules with pixel pitches of 2mm and below are optimally suited for studio backgrounds, live shows and events, which by means of this state-of-the art LED-Technology reach a new level of eye-catching attractiveness.

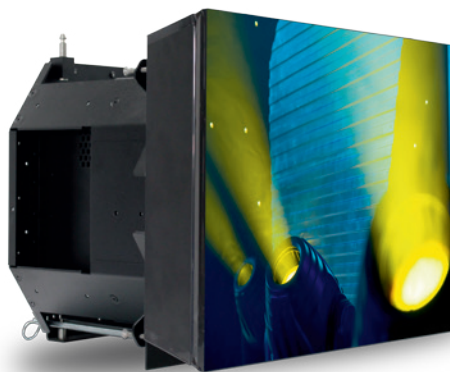

omniSHAPES – FLEXIBLE ALL-ROUNDERS

Genially simple, simply genial – this is how these flexible rear-projection display modules present themselves – ideal for creating video wall configurations in the most varied forms.

omniSHAPES are most effectual when used together to form creatively designed projection walls. Control and image signals can simply be routed from one module to the next. The internal processing thereby guarantees that each omniSHAPE displays the correct image section according to its position. The projected images are – thanks to the outstanding quality of the LED-projection – crystal clear and in perfect, impressively brilliant colour quality. Moreover, they are optimally suited to any colour temperature.

The exceptional practicality of omniSHAPES lies, however, in their variety of forms. Whether in the classic 4:3 format, as pentagon, hexagon or other customer-specific form – they are ideally suited for use in dramatic display screens in the TV studio – and can even be laid as a strikingly attractive floor- which you can actually walk on!



HIGH-BRIGHTNESS PREVIEW MONITORS

These portable LCD monitors are available with screen sizes of 17" and 21", with practically identical technical blueprints.

The robust protective housing and 12-Volt operation make these machines the ideal preview monitors for TV and Film-productions, particularly for outside broadcasting. The displays are equipped with the necessary inputs and timings for broadcasting. Non-reflecting screens with contrast filters and the high brightness of the panel provide excellent picture quality – even under difficult light conditions such as direct sunlight.

WORKING WORLDWIDE
CUSTOMERS WHO TRUST IN EYEVIS TECHNOLOGY.

PERFECT VISUAL SOLUTIONS



A SMALL SELECTION OF FURTHER CUSTOMERS WITH KNOW-HOW FROM EYEVIS

- Astro Malaysia, All Asia Broadcast Centre (ABC) and Cyberjaya Broadcast Centre (CBC) – Kuala Lumpur, Malaysia
12× 46" Video Wall-LCDs (EYE-LCD-4600-M-USN-LD), 4× 67" DLP®-LED-Cubes (EC-60-LHD)
- ERTU Nile News TV Studio – Cairo, Egypt
38× 60" DLP®-Cubes (EC-60-LHD), 10× 50" DLP®-Cubes (EC-50-LSXT+)
- Hessen Broadcasting – Frankfurt, Germany
4× 21" High-Brightness LCD-Production Monitors (EYE-LCD-2100-HB-BC)
- Plazamedia Broadcast Control Room – Ismaning, Germany
24× 46" Edge-LED LCD Monitors (EYE-LCD-4600-LE), 3× 47" LCD Monitors (EYE-LCD-4700-24NB)
- Rai Way National Transmission Network Control Centre – Rome, Italy
9× 60" DLP®-LED-Cubes (EC-60-LHD)
- RTV Slovenia Studio 5 – Ljubljana, Slovenia
19× 50" DLP®-LED-Cubes (EC-50-LSXT+)
- Saarland Broadcasting Transmission Control Room – Saarbrücken, Germany
11× 55" Edge-LED Broadcast-LCD Monitors (EYE-LCD-5500-M-LE-BC)



- **Swiss Radio and Television TV Studios ("10 vor 10", "Kassensturz") – Zurich, Switzerland**
4x 46" Video Wall-LCDs (EYE-LCD-4600-M-USN-LD), 6x openWARP² Image Processing Units
- **Shenyang TV Station – Shenyang, China**
14x 67" DLP®-LED-Cubes (EC-67-LSXT+)
- **Teracom Broadcasting Centre – Stockholm, Sweden**
7x 52" Video Wall-LCDs (EYE-LCD-5200-M-HD), 2x 67" DLP®-LED Cubes (EC-67-LHD), 1x netPIX-4804 Graphics-Controller
- **TV Globo Confed-Cup Studio 2013 – Rio de Janeiro, Brazil**
9x omniSHAPES Rear-Projection Modules (Hexagonal Screens)
- **ZDF TV Production – Mainz, Germany**
26x 17" High-Brightness LCD Production-Monitors (EYE-LCD-1700-HB-BC), 20x 21" High-Brightness LCD Production-Monitors (EYE-LCD-2100-HB-BC)
- **ZDF Capital Studio – Berlin, Germany**
19x 60" DLP®-LED-Cubes (EC-67-LHD-BB)



EYEVIS MAIN OFFICE

- Germany – Reutlingen

PRODUCTION LOCATION

- Germany – Reutlingen

EYEVIS OFFICES INTERNATIONAL

- Germany – Reutlingen
- France – Paris/Saint-Affrique
- Great Britain – Burnley
- Italy – Rome
- Austria – Vienna
- Poland – Kattowitz
- Russia – Moscow
- Scandinavia – Gothenburg (Sweden)
- Spain – Madrid
- South Korea – Seoul
- South-East Asia – Petaling Jaya (Malaysia)
- United Arab Emirates – Abu Dhabi

DISTRIBUTION PARTNERS

- Africa
- Australia
- China
- Europe
- Japan
- Latin America
- USA

Updated information on our projects and products with many photos as well as the possibility of communicating with other interested customers can also be found at:

- twitter.com/eyevis
- www.facebook.com/eyevis
- www.linkedin.com/companies/eyevis



Scan the QR code and visit our website to find more detailed information on all of our products and services, download brochures and data sheets, or watch the product videos.

eyevis GmbH

Hundsschleestrass 23
72766 Reutlingen
Germany

Tel.: +49 (0) 71 21 - 4 33 03-0
Fax: +49 (0) 71 21 - 4 33 03-22

Web: www.eyevis.com
E-Mail: info@eyevis.de